



TASMAN 80



TASMAN
BOATS



TASMAN 80



TASMAN
BOATS

MARCH 2024

WWW.TASMANBOATS.COM.AU



TASMAN 80



TASMAN
BOATS



TASMAN 80



TASMAN
BOATS



TASMAN 80

TASMAN
BOATS





TASMAN 80



TASMAN
BOATS

MARCH 2024



TASMAN BOATWORKS 80 SPECIFICATIONS			
LOA:	8.0 M	CRUISE SPEED:	25 KNOTS
BMAX:	2.8 M	RANGE AT CRUISE:	355 NM @ 25KNOTS, WITH 10% RESERVE
DRAFT:	0.77 M FULL LOAD	DIESEL ENGINE:	1 X YANMAR 8LV370, 370HP AT 3800 RPM
WEIGHT:	2850KG LIGHTSHIP, 4670KG FULL LOAD (EST.)	DRIVE:	SHAFT DRIVING PROP. IN TUNNEL
CONSTRUCTION:	VACUUM INFUSED COMPOSITES	BOW THRUSTER:	ELECTRIC TUNNEL 40KG.F
DESIGN STANDARD:	AS1799/NSCV	FUEL:	600 LITRES
MAXIMUM SPEED:	36 KNOTS HALF LOAD	WATER:	150 LITRES



TASMAN 80



STANDARD INCLUSIONS

- BUILT TO AS1799/AMSA COMMERCIAL STANDARDS
- FOAM FLOATATION AND WATERTIGHT COMPARTMENTS
- VINYL ESTER VACUUM RESIN INFUSED HULL
- VACUUM RESIN INFUSED DECK, CABIN COCKPIT AND INTERIOR
- NO TIMBER USED IN VESSEL, 100% COMPOSITE
- YANMAR 8LV 370HP WITH KMH50A GEARBOX
- DUPLEX STAINLESS STEEL SHAFT 50MM, 4 BLADE BRONZE PROPELLER IN TUNNEL
- DRIPLESS SHAFT SEAL
- WATER COOLED EXHAUST WITH FRP WATERLIFT MUFFLER & BYPASS
- FULLY INSULATED ENGINE COMPARTMENT WITH DECK ACCESS HATCH
- ULLAGE BASED FUEL FILLER SYSTEM (NO OVERFILLS)
- TWIN 300 LITRE, FRP VINYL ESTER FUEL TANKS
- INTEGRATED WATER BALLAST SYSTEM
- 2 X BILGE PUMPS WITH FLOAT SWITCH
- 60 LITRE PLUMBED LIVE BAIT TANK
- 2 BATTERY SYSTEM, HOUSE AND STARTING
- CUSTOM 12V SWITCHBOARD
- LED HOUSE AND RUNNING LIGHTS
- 150 LITRE FRP WATER TANK AND 12V PRESSURE PUMP
- ELECTRIC MARINE TOILET AND BATHROOM SINK IN ENCLOSED HEAD
- TOUGHENED GLASS WINDOWS IN CABIN
- FIXED FRONT CABIN WINDOW, SLIDING SIDE GLASS
- 2 X CABIN ROOF HATCHES
- 1 X FOREDECK HATCH
- LONESTAR ANCHOR WINCH/ROLLER WITH CHAIN/ROPE/ANCHOR
- FWD DECK LOCKER WITH HATCH
- STAINLESS STEEL/BRONZE RUDDER, SHAFT AND TILLER
- HYDRAULIC STEERING
- ZIPWAKE INTERCEPTORS
- 40KG.F SLEIPNER ELECTRIC BOW THRUSTER
- HELM SEAT BOXES WITH UPHOLSTERED SEAT CUSHION & BOLSTER
- STARBOARD SINK/TACKLE STATION
- PORT TWIN MOULDED INSULATED SEAT BOXES WITH REMOVABLE TABLE CONVERTING TO BERTH, UPHOLSTERED SEAT CUSHIONS & BOLSTERS
- TWIN INSULATED KILL TANKS/COCKPIT FLOOR LOCKERS
- MOULDED SIDE POCKETS PORT AND STARBOARD
- SELF DRAINING COCKPIT
- TRANSOM DOOR
- LINED FORWARD CABIN WITH EVA FOAM FLOORING

OPTIONS

- SECOND HELM AFT
- GYRO STABILISER IN AFT COMPARTMENT
- 65L DRAW FRIDGE IN STARBOARD SEATBOX
- FRIDGE PLATE/COMPRESSOR FITTED TO INSULATED ICE CHEST PORT SIDE
- HOT WATER SYSTEM
- FWD CABIN CUSHIONS
- HIGH FLOW SALT WATER DECK WASH PUMP
- WINDSCREEN WIPER FOR HELM SIDE
- BOW AND COCKPIT RAILS
- ROOF RAILS AND ROCKET LAUNCHERS
- SWIM PLATFORM
- HULL AND DECK GELCOAT COLOUR OPTIONS
- SYNTHETIC TEAK DECKING IN COCKPIT/AFT SIDE DECKS
- GAS STRUTS FOR COCKPIT HATCHES
- FULL COMMERCIAL SURVEY TO AMSA/NSCV STANDARDS (2D/C)

NAVAL ARCHITECTURE BY 

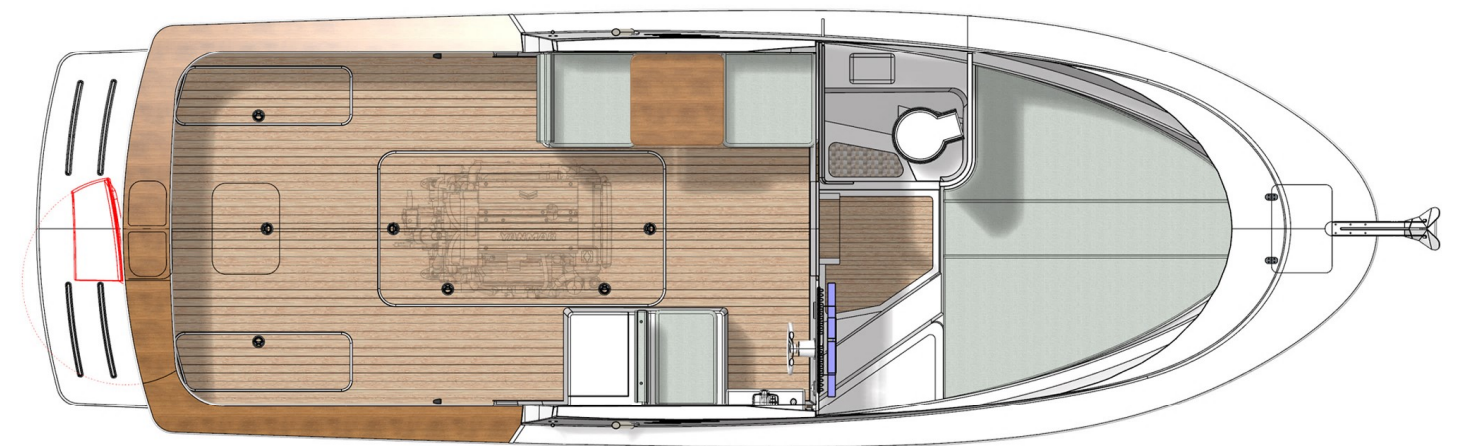

TASMAN 80



TASMAN
BOATS

TASMAN BOATWORKS 80 SPECIFICATIONS			
LOA:	8.0 M	CRUISE SPEED:	25 KNOTS
BMAX:	2.8 M	RANGE AT CRUISE:	355 NM @ 25KNOTS, WITH 10% RESERVE
DRAFT:	0.77 M FULL LOAD	DIESEL ENGINE:	1 X YANMAR 8LV370, 370HP AT 3800 RPM
WEIGHT:	2850KG LIGHTSHIP, 4670KG FULL LOAD (EST.)	DRIVE:	SHAFT DRIVING PROP. IN TUNNEL
CONSTRUCTION:	VACUUM INFUSED COMPOSITES	BOW THRUSTER:	ELECTRIC TUNNEL 40KG.F
DESIGN STANDARD:	AS1799/NSCV	FUEL:	600 LITRES
MAXIMUM SPEED:	36 KNOTS HALF LOAD	WATER:	150 LITRES

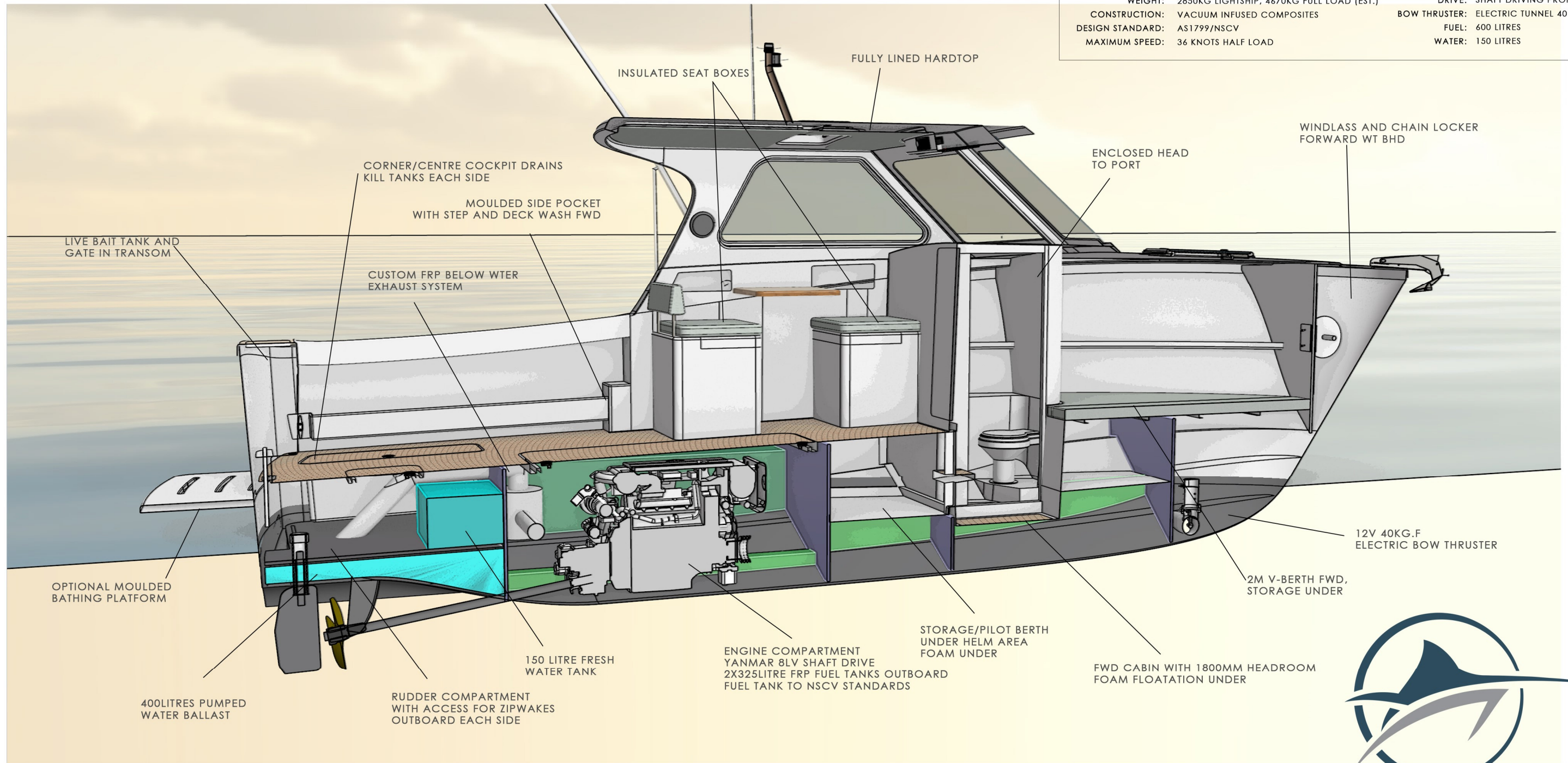

TASMAN 80



TASMAN
BOATS